

LED-HEADLIGHT LAMP



LED-HL upgrade lamp

Please read through the instructions carefully before use and keep them properly to facilitate reference in the future

Part of Simply Brands simply-brands.com

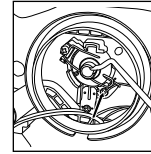

- Install the heat sink onto the lamp.

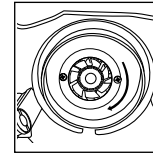

- Connect the control box to the two connectors on the lamp.

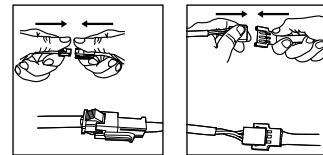

- Place the wiring harness into the chamber of the lamp. Be careful to avoid the air inlet of the fan.

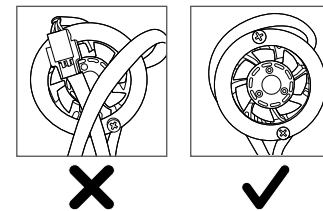

- Put on the air-tight cover for the lamp.

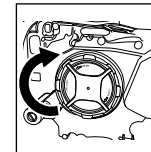

- Check if the lamp works normally and if the light pattern is okay. If the light pattern is too low or too high, adjust the horizontal adjustment knob for the lamp the position is correct.



- Dispose correctly as removed halogen lamp.

7 Troubleshooting

If the LED-HL lamp does not turn on, please check if any of the following conditions exists:

1. Are the positive and negative power connectors properly connected?
2. Check if the power switch for the lamp is turned on.
3. Make sure that there is sufficient power in the battery.

8 Recycling

 This product is designed in compliance with applicable requirements of European Directive 2002/96/EC. Its parts and elements may be recycled for reuse.

 Do not discard this product carelessly. Certain substances in the electronic elements can be harmful for the environment and humans.

6 Installation steps for reflector lamps

- Twist to open the air-tight cover for the original headlight.

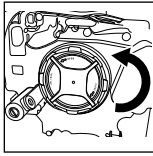
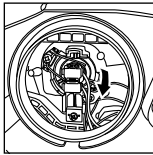
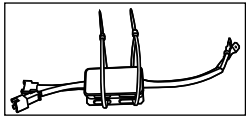

Figure-2

- Loosen the spring latch and remove the halogen lamp from the existing headlight assembly.



- Insert the plastic ties into the pre-secured holes on the control box.



- Insert the ties into the wiring harness for the lamp.

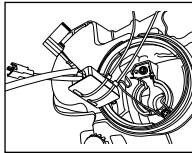

- Fasten the ties.

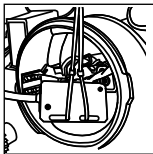

- Connect to power and make sure that the positive and negative wires are properly connected. If they are connected wrong, please switch and connect them again.

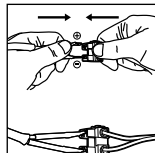

- Insert the control box into the internal empty chamber of the lamp.

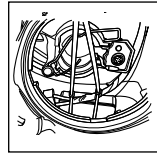

- Unscrew the LED-HL heat sink from the lamp.

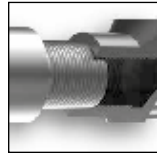

- Adjust the installation angle of the central plate.

- (1). If the stop of the existing halogen lamp is vertically up and down, it is not required to adjust the installation angle of the central plate. Otherwise, it is required to adjust the installation angle of the central plate for the LED-HL lamp.
- (2). Use the Allen key to loosen the three set screws of the central plate as is shown below.

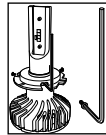

- (3). Turn the central plate until the LED burner is aligned vertically in the reflector; the LEDs shining to the left and the right, as shown on below picture. (see the hollow arrows in the following figure) and that the LED shines toward the right and the left sides of the reflector. Then, fasten the screws for the central plate.

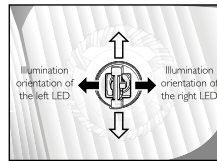

- (4). The low beam should finally be equipped with the clear bright-dark cut-off line shown in the lower left figure; this is meant to reduce glare experienced by oncoming drivers.

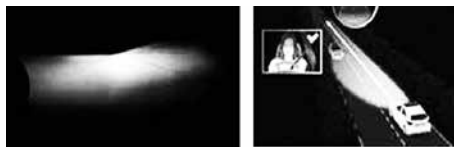

- Install the LED-HL lamp into the headlight and buckle the spring latch. Attention: do not let the spring latch touch the wires.

1 Packing list

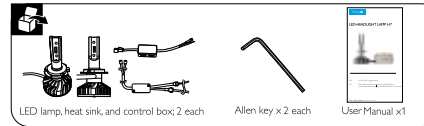

Also required: Plastic tie x8

2 Product features

Operating voltage: 13.2V
Power: 25W±15%
Light flux: 1760lm±20%
Color temperature: 6000K±500

3 Important

Before you install the LED-HL lamp, please read through the following information carefully.

⚠ Precautions

- This product can only be used with a car power input of 12V.
- This product can only be used in headlights with halogen lamps.

Usable with: Projector headlights

Usable with: Reflector headlights



- Prior to installation, please make sure that the LED-HL lamp does not have defects such as damage or rupture.

- While installing and removing the lamp, do not touch the blades of the fan (see figure below) or the LED cores directly, to avoid damaging them.

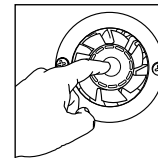

- During installation, do not place the guide wire or control box at the air inlet of the fan, to avoid affecting the incoming air and interference with the blades of the fan.

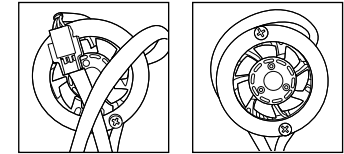

- During installation, do not directly pull the guide wire with your hand; touch the connector directly.

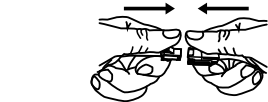
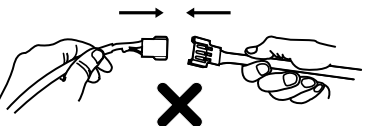
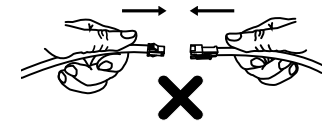

- The LED-HL lamp has a relatively high temperature; do not let it get close to flammable materials or parts.
- For the best heat-sink effects, do not wrap the control box completely with tape or sponge.



⚠ Warnings

- When working, the LED-HL lamp and the LED drive box will be at a very high temperature. Do not touch them directly with fingers or skin, to avoid scalding.

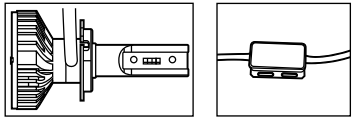

- The LED illumination of the LED-HL lamp is of high intensity; do not look directly at the LED-HL lamp, to avoid eye damage.
- Before you remove the halogen lamp, make sure that the lamp's temperature has dropped to room temperature, to avoid burning fingers or skin.
- Do not let the LED-HL lamp get exposed to dust, grease, or stains, or scratch the surface of the LED; this will damage the LED-HL lamp.
- Do not let children touch the LED-HL product.

△ Other Information

- Please make sure that you purchase the LED-HL lamp through correct channels.
- After the lamp is installed, please check if the light pattern is okay, and make sure that the indicators on the dash board are working normally and that nothing is abnormal.
- After the lamp is installed, please check whether the air-tight cover is properly sealed to avoid undesirable sealing; and whether the control box and the wiring harness are firmly in place, and not interfering with other parts inside the lamp or the fan above the lamp.

4 Pre-installation Information

- Check to make sure that the inside diameter of the air-tight cover for your lamp is at least 60 mm. If it is too small, there is the risk of unsuccessful installation of the heat sink and the control box.

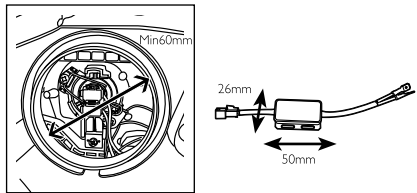

Figure-1

- The LED-HL lamp is not for use with all types of cars. Please consult a professional sales representative.
- Please have a technician at a professional service location install the LED-HL lamp.
- If it is found after the LED-HL lamp is installed that there is no cut-off line for the low-beam light pattern, please switch back to your prior halogen lamp.
- Applicable car types: Please refer to the overview of applicable cars.

5 Installation steps for projector lamps

- Twist to open the air-tight cover for the original headlight.

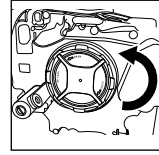
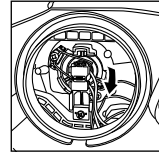
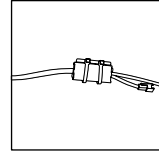

Figure-2

- Loosen the spring latch and remove the halogen lamp from the existing headlight assembly.



- Secure the control box with two ties, as shown below.



- Secure the control box with the third and the fourth ties, as shown below.

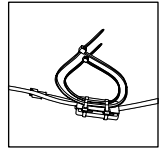

- Secure the ties to the neck of the lamp reflector:

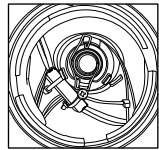

- Fasten the ties and finally secure the control box as follows.

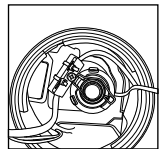

- Connect to power and make sure that the positive and negative wires are properly connected. If they are connected incorrectly, please switch and connect them again.

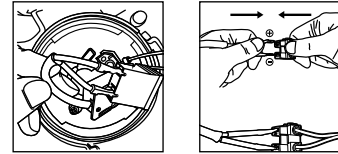

- Unscrew the LED-HL heat sink from the lamp.



- Adjust the installation angle of the central plate.

- (1) If the stops of the existing halogen lamp is vertically up and down, it is not required to adjust the installation angle of the central plate. Otherwise, it is required to adjust the installation angle of the central plate for the LED-HL lamp.
- (2) Use the Allen key to loosen the three set screws of the central plate as is shown below.



- (3) Turn the central plate until the LED burner is aligned vertically in the reflector; the LEDs shining to the left and the right, as shown on below picture. (see the hollow arrows in the following figure) and that the LED shines toward the right and the left sides of the reflector. Then, fasten the screws for the central plate.

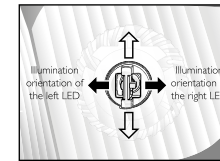

- (4) The low beam should finally be equipped with the clear bright-dark cut-off line shown in the lower left figure; this is meant to reduce glare experienced by oncoming drivers.

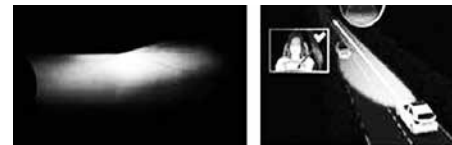

- Install the LED-HL lamp into the headlight and buckle the spring latch. Attention: do not let the spring latch touch the wires.

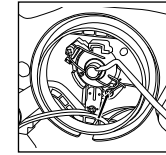

- Install the heat sink onto the lamp.

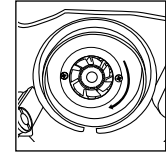

- Connect the control box to the two connectors on the lamp.

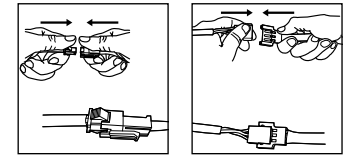

- Place the wiring harness into the chamber of the lamp. Be careful to avoid the air inlet of the fan.

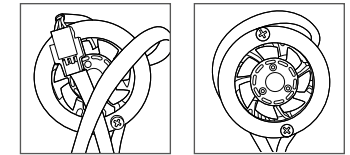

- Put on the air-tight cover for the lamp.

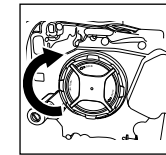

- Check if the lamp works normally and if the light pattern is okay. If the light pattern is too low or too high, adjust the horizontal adjustment knob for the lamp the position is correct.



- Dispose correctly as removed halogen lamp.